

Product Datasheet

3-port 10/100M Industrial Ethernet Fiber Switch (ONV-IPS1032F)



OVERVIEW

The ONV-IPS1032F is a 10/100M industrial Ethernet fiber switch independently developed by ONV. It has 2*10/100Base-TX RJ45 ports and 1*155M uplink SC fiber port. Each port can support full line-rate forwarding.

The ONV-IPS1032F has excellent industrial field environment adaptability (including mechanical stability, climate adaptability, electromagnetic environment adaptability, etc.). protection level is IP30, supports dual redundant power supply, low power consumption and no fan, 5-year warranty. It is suitable for industrial scenes such as intelligent transportation, rail transit, electric power, mining, metallurgy, and green energy construction to form a cost-effective and stable communication network. Unmanaged mode, plug and play, no configuration, easy to use.

FEATURE

■ 10/100M access, Fast Ethernet

- ◇ Support non-blocking wire-speed forwarding.
- ◇ Support full-duplex based on IEEE802.3x and half-duplex based on Backpressure.
- ◇ Support 10/100M Ethernet port and 155M SC optical port combination, which enables users to flexibly build networking to meet the needs of various scenarios.

■ Stable and reliable

- ◇ CCC, CE, FCC, RoHS.
- ◇ The user-friendly panel can show the device status through the LED indicator of PWR, Link.
- ◇ Low power consumption, no fan, aluminum shell, excellent heat dissipation to ensure the stable operation of the switch.

TECHNICAL SPECIFICATION

Model	ONV-IPS1032F
Interface Characteristics	
Fixed Port	1*DC5521 power socket 1*155M uplink SC fiber port (Data) 2*10/100Base-TX RJ45 ports (Data) 2 set of V+, V- redundant DC power interface (3P Phoenix terminal)
Ethernet Port	Port 1-2 support 10/100Base-TX auto-sensing, full/ half duplex MDI/ MDI-X self-adaption
Twisted Pair	10BASE-T: Cat3,4,5 UTP (≤100 meters)
Transmission	100BASE-TX: Cat5 or later UTP (≤100 meters)
Fiber Port	Default optical module is single-mode dual fiber 20km, SC port
Optical Cable/ Distance	Multi-mode: 850nm/ 0-550m, 1310nm/ 0-2km Single-mode: 1310nm/ 0-40km, 1550nm/ 0-120km
Chip Parameter	



Network Protocol	IEEE802.3 10BASE-T, IEEE802.3i 10Base-T, IEEE802.3u 100Base-TX IEEE802.3x
Forwarding Mode	Store and Forward(Full Wire Speed)
Switching Capacity	1.0Gbps (no-blocking)
Forwarding Rate@64byte	0.45Mpps
MAC	2K
Buffer Memory	512Kb
Jumbo Frame	2048B
LED Indicator	Power: PWR (Green), Network: Link(Yellow), Fiber port:3 (Green)
Power Supply	
Power Consumption	Standby<3W, Full load<5W
Operating Voltage	DC12-48V, 3P industrial Phoenix terminal, support anti-reverse protection.
Power Supply	No, optional 24W/24V industrial power supply
Physical Parameter	
Operation TEMP / Humidity	-40~+75°C, 5%~90% RH Non condensing
Storage TEMP / Humidity	-40~+85°C, 5%~95% RH Non condensing
Dimension (L*W*H)	98*88*30mm
Net /Gross Weight	<0.2kg / <0.3kg
Installation	Desktop, 35mm DIN rail
Certification & Warranty	
Lightning Protection	Protection level: IP30, Lightning protection: 6KV 8/20us IEC61000-4-3 (RS):10V/m (80~1000MHz) FCC Part 15/CISPR22 (EN55022): Class B IEC61000-6-2 (Common Industrial Standard) IEC61000-4-9 (Pulsed magnet field): 1000A/m IEC61000-4-10 (Damped oscillation): 30A/m, 1MHz

	<p>IEC61000-4-12/18 (Shockwave): CM 2.5kV, DM 1kV</p> <p>IEC61000-4-4(EFT): Power cable:±4kV, Data cable: ±2kV</p> <p>IEC61000-4-16 (Common-mode transmission): 30V, 300V, 1s</p> <p>IEC61000-4-2 (ESD): ±8kV contact discharge, ±15kV air discharge</p> <p>IEC61000-4-6 (Radio frequency transmission): 10V(150kHz~80MHz)</p> <p>IEC61000-4-8 (Power frequency magnetic field):100A/m, 1000A/m,1s-3s</p> <p>IEC61000-4-5 (Surge): Power cable: CM±4kV/ DM±2kV, Data cable: ±4kV</p>
Mechanical Properties	IEC60068-2-6 (Anti Vibration), IEC60068-2-32 (Free Fall), IEC60068-2-27 (Anti Shock)
Certification	CCC, CE mark, commercial, CE/LVD EN62368-1, FCC Part 15 Class B, RoHS
Warranty	5 years, lifelong maintenance.

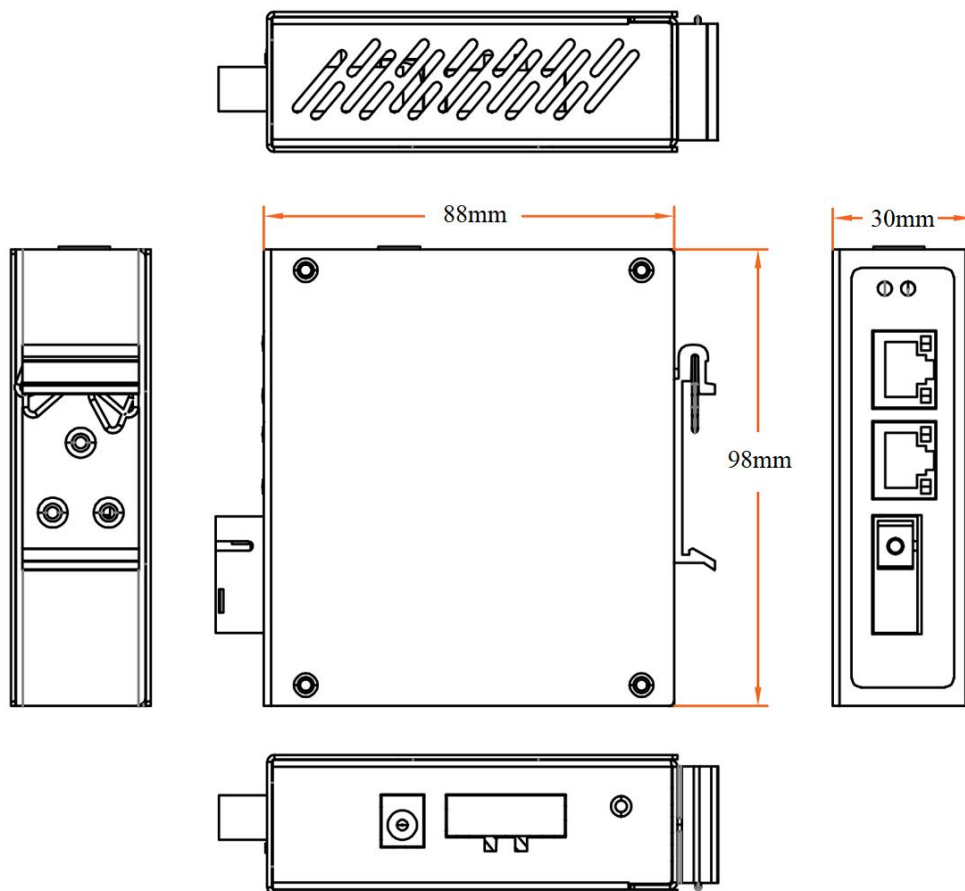
DIMENSION



APPLICATION

-  **Plug and play**
-  **Wide temperature range**
-  **DIN Rail installation**

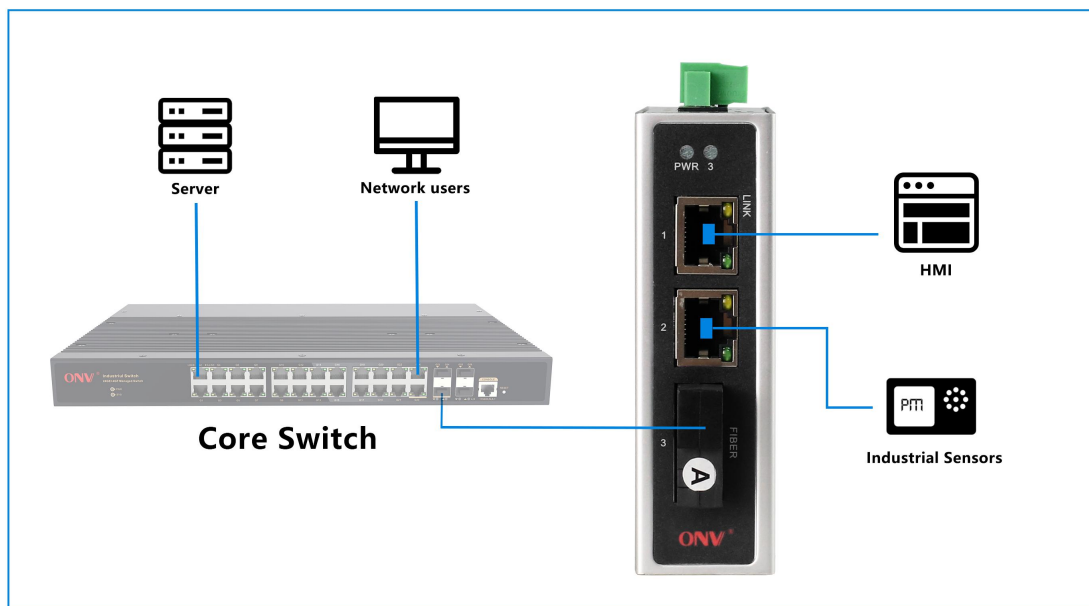
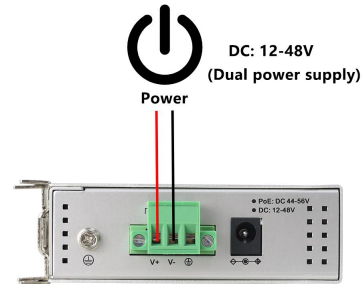

ORDERING INFORMATION

Model	Description	Recommended Power Supply
ONV-IPS1032F	Unmanaged industrial Ethernet fiber switch with 2*10/100M RJ45 ports and 1*155M uplink SC port (1310nm/20km single-mode dual fiber module). It can support dual DC redundant power input and DIN rail mounting.	24W/24V
ONV-IPS1032F -A	Unmanaged industrial Ethernet fiber switch with 2*10/100M	24W/24V

	RJ45 ports and 1*155M uplink SC port (1310nm/20km single-mode single fiber module). It can support dual DC redundant power input and DIN rail mounting.	
ONV-IPS1032F -B	Unmanaged industrial Ethernet fiber switch with 2*10/100M RJ45 ports and 1*155M uplink SC port (1550nm/20km single-mode single fiber module). It can support dual DC redundant power input and DIN rail mounting.	24W/24V

Note: The power supply is not included, and needs to be purchased separately

PACKING LIST

	Content	Qty	Unit
Packing List	3-port 10/100M industrial Ethernet fiber switch	1	SET
	User Guide	1	PC
	Warranty Card	1	PC

POWER SUPPLY

Product	Model	Description	Unit
24W DIN Rail Industrial Power Supply	GWS-DP24-24	DIN Rail 24W single set of output power supply Input Voltage: AC100V~240V 50-60Hz, 0.35A Output Voltage: DC24V, 1.0A Operation Temperature: -40°C to +70°C	PC

CONTACT US

ONV Optical Network Video Technologies (Shenzhen) Co., Ltd.

Tel: 0086-755-33376606

Fax: 0086-755-33376608

WeChat: ONV-PoE-IoT

Email: onv@onv.com.cn

Skype: [onv@onv.com.cn](https://www.skype.com/people/onv@onv.com.cn)

Website: www.onvcom.com

Headquarter Address: Room 1003, Block D, Terra Building, Futian District, Shenzhen, China

Factory Address: Floor 4-6, Building A, Senyutai Industrial Park, No. 111, Huaning Road, Xinshi

Community, Dalang Street, Longhua District, Shenzhen, China

