

Product Datasheet

18-port Full Gigabit PoE Switch

(ONV-H3016PS-250)



OVERVIEW

The ONV-H3016PS-250 is a full gigabit unmanaged PoE switch independently developed by ONV. It has 18*10/100/1000Base-T RJ45 ports. Port 1-16 can support PoE+ power supply, and single-port PoE power up to 30W. As a PoE power supply device, it can automatically detect and recognize the power receiving equipment that meets the standard and supply power through the network cable. It can supply power to PoE terminal equipment such as wireless AP, IP camera, VoIP phone, video access control intercom, etc. through a network cable to meet the network environment that needs a high-density PoE power supply. It is suitable for hotels, campuses, factory quarters, and small and medium-sized enterprises to form an economy efficient network. Unmanaged mode, plug and play, no configuration, easy to use.

FEATURE

■ Full gigabit port

- ◇ Support non-blocking wire-speed forwarding.
- ◇ Support full-duplex based on IEEE802.3x and half-duplex based on Backpressure.
- ◇ Provide Gigabit Ethernet ports and dual RJ45 ports uplink for flexible networking and meets the networking requirements of various scenarios.

■ Smart PoE power supply

- ◇ 16*10/100/1000Base-T PoE ports, meeting the needs of security monitoring, teleconferencing system, wireless coverage, and other scenarios.
- ◇ Priority system for PoE port, it will supply power to the high priority level port first when the power budget is insufficient and avoid overwork of the device.
- ◇ Comply with PoE+ power standard, automatically identify PoE devices for power without damaging non-PoE devices, and the single port max PoE output power is 30W.

■ Stable and reliable, easy to use

- ◇ CCC, CE, FCC, RoHS.
- ◇ The user-friendly panel can show the device status through the LED indicator of PWR, Link, and PoE.
- ◇ Self-developed power supply, high redundancy design, providing a long term and stable PoE power output.
- ◇ Low power consumption, galvanized steel casing, excellent heat dissipation to ensure the stable operation of the switch.

TECHNICAL SPECIFICATION

Model	ONV-H3016PS	ONV-H3016PS-250
Interface Characteristics		
Fixed Port	16*10/100/1000Base-T PoE ports (Data/Power) 2*10/100/1000Base-T uplink RJ45 ports (Data)	
Ethernet Port	Port 1-16 support 10/100/1000Base-T auto-sensing, full/half duplex MDI/MDI-X self-adaption	
Twisted Pair Transmission	10BASE-T: Cat3, 4, 5 UTP (≤100 meters) 100BASE-TX: Cat5 or later UTP (≤100 meters) 1000BASE-T: Cat5e or later UTP (≤100 meters)	
Chip Parameter		
Network Protocol	IEEE802.3 10BASE-T, IEEE802.3i 10Base-T IEEE802.3u 100Base-TX, IEEE802.3ab 1000Base-T, IEEE802.3x	

Forwarding Mode	Store and Forward(Full Wire Speed)	
Switching Capacity	36Gbps (Non-blocking)	
Forwarding Rate@64byte	26.78Mpps	
MAC	2K	
Buffer Memory	2M	
Jumbo Frame	9.2k	
LED Indicator	Power: PWR (Green), Network: Link (Green), PoE: PoE (Green)	
PoE & Power Supply		
PoE Port	Port 1 to 16	
Power Supply Pin	1/2(+) 3/6(-)	
Max Power Per Port	30W, PoE+	
Total PWR / Input Voltage	160W/ (AC100-240V)	250W/ (AC100-240V)
Power Consumption	Standby <13W, Full load <160W	Standby <13W, Full load <250W
Power Supply	Built-in power supply, AC100~240V 50-60Hz, 3.0A	Built-in power supply, AC100~240V 50-60Hz, 4.1A
Physical Parameter		
Operation TEMP / Humidity	-20~+55°C, 5%~90% RH Non condensing	
Storage TEMP / Humidity	-40~+75°C, 5%~95% RH Non condensing	
Dimension (L*W*H)	270*181*44.5mm	
Net /Gross Weight	1.4kg / 1.9kg	1.6kg / 2.0kg
Installation	Desktop, 19 inch 1U cabinet	
Certification & Warranty		
Lightning Protection	Lightning protection: 4KV 8/20us, Protection level: IP30	
Certification	CCC, CE mark, commercial, CE/LVD EN62368-1, FCC Part 15 Class B, RoHS	

Warranty

1 year, lifelong maintenance.

DIMENSION

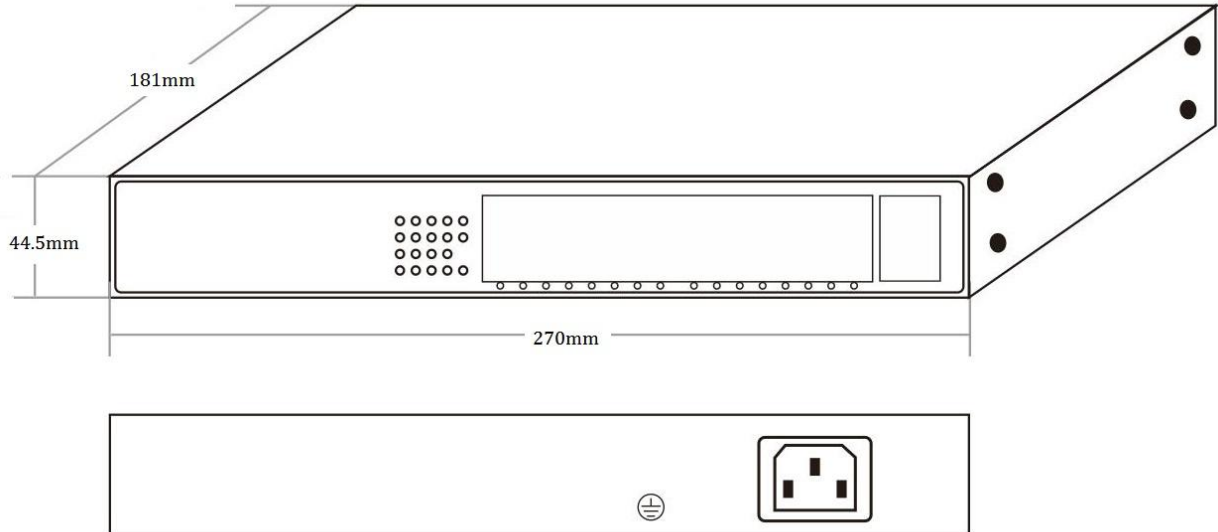

APPLICATION

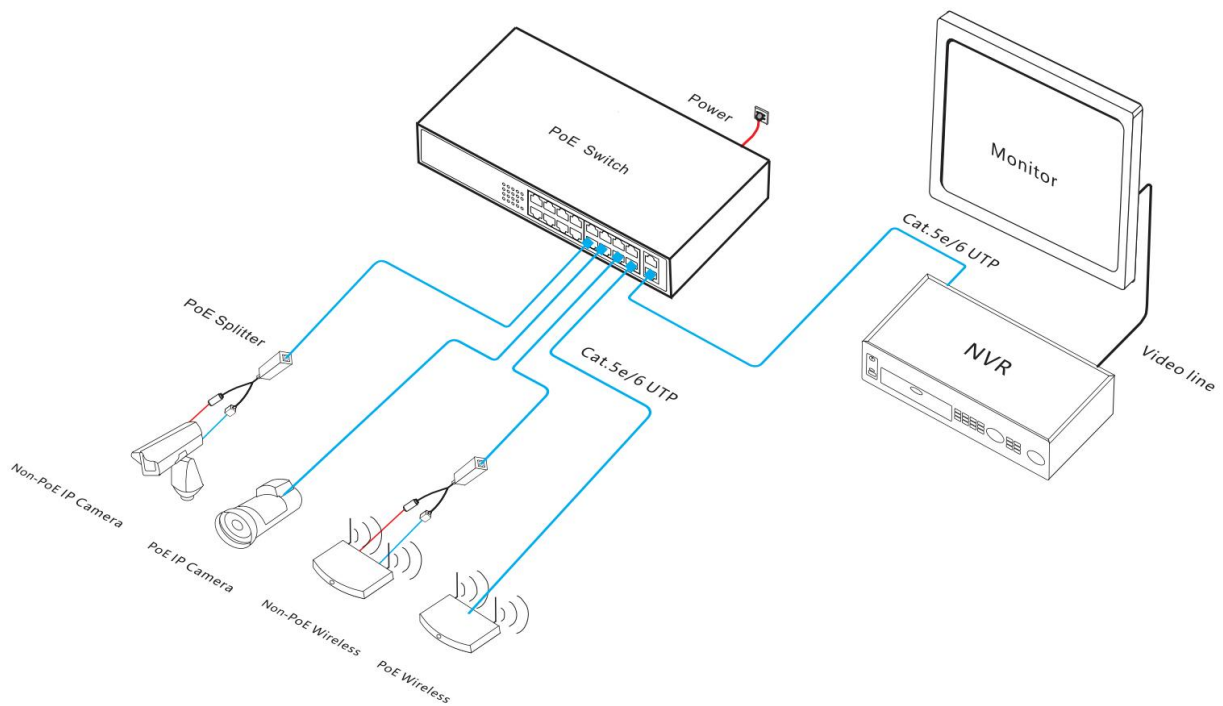

ORDERING INFORMATION

Model	Description	Built-in Power Supply
ONV-H3016PS	Unmanaged PoE switch with 16*10/100/1000M RJ45 ports and 2*10/100/1000M RJ45 ports. Port 1-16 support PoE+	160W
ONV-H3016PS-250	power supply. Built-in power supply	250W

PACKING LIST

	Content	Qty	Unit
Packing List	18-port full gigabit PoE switch	1	SET
	AC Power Line	1	PC
	Hardware Mounting Kit	1	SET
	User Guide	1	PC
	Warranty Card	1	PC

CONTACT US

ONV Optical Network Video Technologies (Shenzhen) Co., Ltd.

Tel: 0086-755-33376606

Fax: 0086-755-33376608

WeChat: ONV-PoE-IoT

Email: onv@onv.com.cn

Skype: onv@onv.com.cn

Website: www.onvcom.com

Headquarter Address: Room 1003, Block D, Terra Building, Futian District, Shenzhen, China

Factory Address: Floor 4-6, Building A, Senyutai Industrial Park, No. 111, Huaning Road, Xixiang

Community, Dalang Street, Longhua District, Shenzhen, China

