

## Product Datasheet

# 2-port Gigabit Single-mode Dual Fiber Media Converter (ONV1110-SLX-F)



## OVERVIEW

The ONV1110-SLX-F is a Gigabit fiber media converter independently developed by ONV. It has 1\*10/100/1000Base-T RJ45 port and 1\*1.25G uplink SFP fiber port. Users can select different optical modules, such as multi-mode dual fiber, single-mode dual fiber, and single-mode single fiber. The media converter adopts enterprise-level telecom-grade chip solutions with stable performance, excellent quality, and high-cost performance. It is suitable for optical fiber access application scenarios such as security monitoring, wireless coverage, intelligent transportation, and safe cities to form a cost-effective and stable communication network. Unmanaged mode, plug and play, no configuration, and easy to use.

## FEATURE

### ■ Gigabit photoelectric Ethernet conversion transmission

- ◇ Support non-blocking wire-speed forwarding.
- ◇ Support full-duplex based on IEEE 802.3x and half-duplex based on Backpressure.

- ◇ Support Gigabit RJ45 port and SFP fiber port combination, which enables users to flexibly build networking to meet the needs of various scenarios.

#### ■ Easy to use

- ◇ Support full-duplex/half-duplex working mode with auto-negotiation function.
- ◇ Automatic identification of twisted pair MDI/MDI-X cross lines and parallel lines.
- ◇ LED working status indication for network diagnosis and fault checking, reducing maintenance workload.
- ◇ Compatible with IEEE802.3ab 1000Base-T, IEEE802.3z 1000Base-X network protocols, port 10/100/1000M rate auto-negotiation.
- ◇ Plug and play, no configuration, centralized power supply, and centralized connection management through 2U-14 slot rack.

#### ■ Stable and reliable

- ◇ CCC, CE, FCC, RoHS.
- ◇ Low power consumption, no fan, galvanized steel housing, and excellent heat dissipation ensure stable operation of the product.

## TECHNICAL SPECIFICATION

| Model                            | ONV1110-MLX-F   | ONV1110-SLX-F                                | ONV1110S-SLX-A/B                               |
|----------------------------------|---|--|--|
| <b>Interface Characteristics</b> |   |  |  |
| Fixed Port                       | 1*1.25G uplink SFP fiber port (Data)<br>1*10/100/1000Base-T RJ45 port (Data)  |  |  |
| Ethernet Port                    | 10/100/1000Base-T auto-sensing, full/ half duplex MDI/ MDI-X self-adaption  |  |  |
| Twisted Pair<br>Transmission     | 10BASE-T: Cat3,4,5 UTP (≤100 meters)<br>100BASE-TX: Cat5 or later UTP (≤100 meters)<br>1000BASE-T: Cat5e or later UTP (≤100 meters) |  |  |
| Optical Fiber Port               | 1.25G multi-mode dual<br>fiber LC interface   | 12.5G single-mode dual<br>fiber LC interface | 1.25G single-mode<br>single fiber LC interface |

|                                     |  |  |
|-------------------------------------|--|--|
| Optical Cable/ Distance             | Multi-mode: 850nm/<br>0-550m   | Single-mode: 1310nm/ 0-40km, 1550nm/ 0-120km |
| <b>Chip Parameter</b>               |  |  |
| Network Protocol                    | IEEE 802.3 10BASE-T, IEEE 802.3i 10Base-T, IEEE 802.3u 100Base-TX,<br>IEEE 802.3ab 1000Base-T, IEEE 802.3z 1000Base-X, IEEE 802.3x |  |
| Forwarding Mode                     | Store and forward (Full wire speed)  |  |
| Switching Capacity                  | 2.0Gbps (non-blocking)   |  |
| Forwarding Rate<br>@64byte          | 3.0Mpps  |  |
| MAC                                 | 2K   |  |
| Buffer Memory                       | 1M   |  |
| LED Indicator                       | Power: PWR (Green), Network: L/A (Green), Half/full duplex: FDX (Green),<br>Rate: 100/1000 (Green: 1000M/on, 100M/off)             |  |
| <b>Power Supply</b>                 |  |  |
| Total PWR/ Input<br>Voltage         | 3.5W/ (5VDC)   |  |
| Power Consumption                   | Standby<1W, Full Load<4W   |  |
| <b>Physical Parameter</b>           |  |  |
| Operation Temp/<br>Humidity         | -20°C~+55°C, 5%~90% RH Non condensing  |  |
| Storage Temp/ Humidity              | -40°C~+85°C, 5%~95% RH Non condensing  |  |
| Dimension (L*W*H)                   | 106.7*72*26mm  |  |
| Net /Gross Weight                   | 0.3kg / 0.45kg   |  |
| Installation                        | Desktop, 2U-14 slot rack   |  |
| <b>Certification &amp; Warranty</b> |  |  |
| Lightning Protection                | Lightning protection: 4KV 8/20us, Protection level: IP30   |  |
| Certification                       | CCC, CE mark, commercial, CE/LVD EN62368-1, FCC Part 15 Class B, RoHS  |  |
| Warranty                            | 3 years, lifelong maintenance.   |  |

# DIMENSION

# APPLICATION

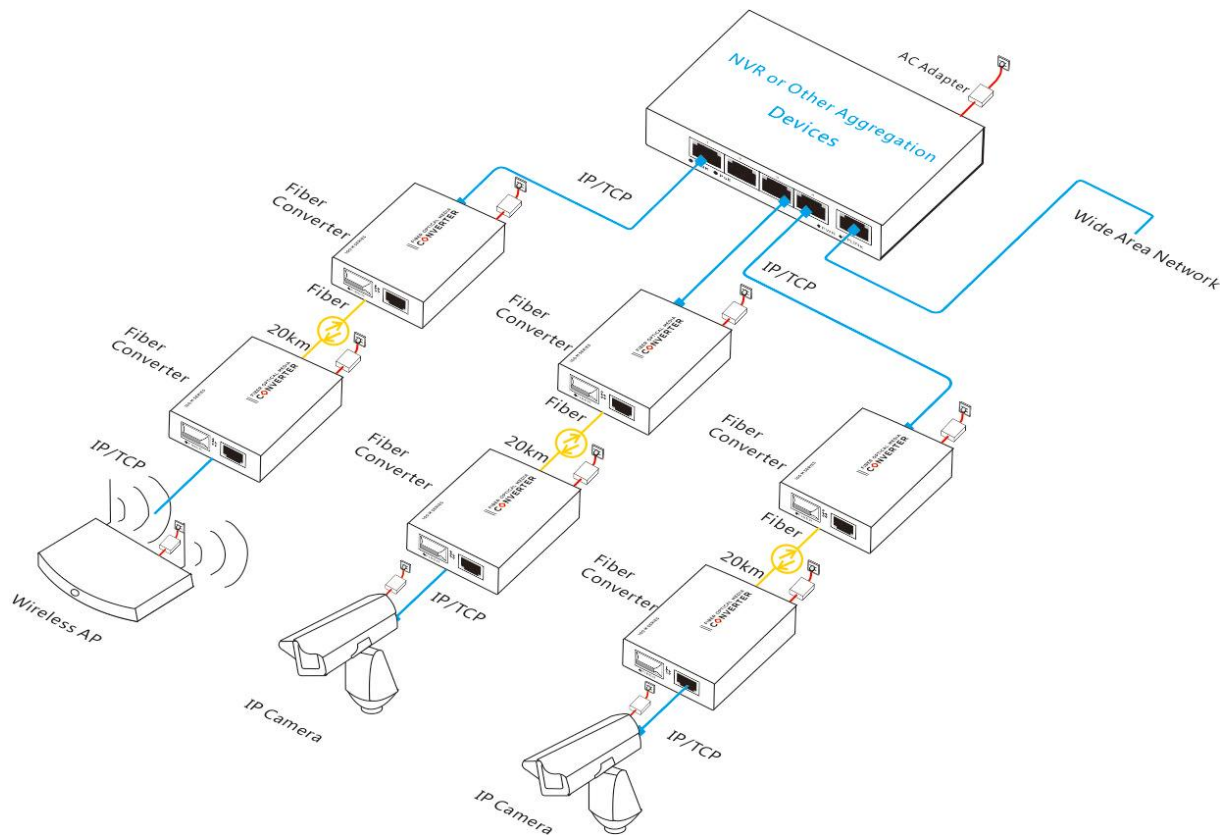

## ORDERING INFORMATION

| Model          | Description   |
|----------------|---|
| ONV1110-MLX-F  | Gigabit <b>multi-mode dual fiber</b> media converter with 1*10/100/1000M RJ45 port and 1*1.25G SFP fiber port. Total power is 4W. 850nm/ 0-550m. External power supply.     |
| ONV1110-SLX-F  | Gigabit <b>single-mode dual fiber</b> media converter with 1*10/100/1000M RJ45 port and 1*1.25G SFP fiber port. Total power is 4W. 1310nm/ 0-20km. External power supply.   |
| ONV1110S-SLX-A | Gigabit <b>single-mode single fiber</b> media converter with 1*10/100/1000M RJ45 port and 1*1.25G SFP fiber port. Total power is 4W. 1310nm/ 0-20km. External power supply. |
| ONV1110S-SLX-B | Gigabit <b>single-mode single fiber</b> media converter with 1*10/100/1000M RJ45 port and 1*1.25G SFP fiber port. Total power is 4W. 1550nm/0-20km. External power supply.  |

## PACKING LIST

|              | Content   | Qty | Unit |
|--------------|---|-----|------|
| Packing List | 2-port Gigabit single-mode dual fiber media converter | 1   | Set  |
|              | User Guide  | 1   | PC   |
|              | Warranty Card and Certificate of Conformity           | 1   | PC   |

## CONTACT US



Optical Network Video Technologies (Shenzhen) Co., Ltd.

Tel: 0086-755-33376606

Fax: 0086-755-33376608

WeChat: ONV-PoE-IoT

Email: onv@onv.com.cn

Skype: onv@onv.com.cn

Website: [www.onvcom.com](http://www.onvcom.com)

Headquarter Address: Room 1003, Block D, Terra Building, Futian District, Shenzhen

Factory Address: Building B3, Galaxy Artificial Intelligence Industrial Park, No. 333, Zhongkai 6th Road, Chenjiang Street, Zhongkai High-tech Zone, Huizhou

